

# A308i

## Quick Installation Guide

### Packaging list

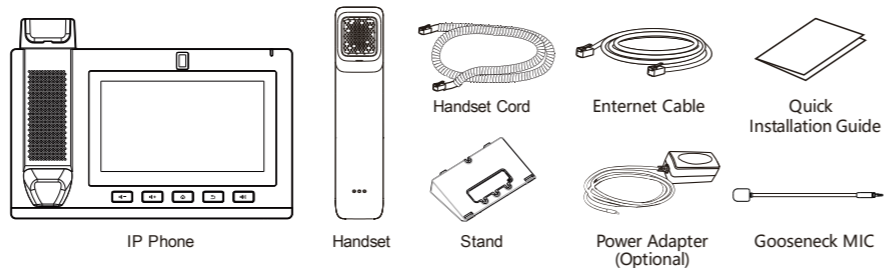

### Screen icon

In hands-free mode	Call is on hold	New SMS	Dialed call
In headset mode	Auto-answering activated	New VM Messages	Missed call(s)
In handset mode	Call Forward activated	Do not disturb activated	Forward call
Mute activated	Internet is disconnected	Missed call(Status bar)	Enable Blacklist
Ringer off	Internet is connected	Received call	EnableWhite List

### Indicator & Keys features

Message waiting indicator	In idle mode or during ringing: increase or decrease ringer volume In communication: increase or decrease earpiece, headset or hands-free volume
Home Key, Return to standby home page	Hand-free key, Activate/deactivate hands free
Return key,Return to the previous menu / page	

### Desktop Installation

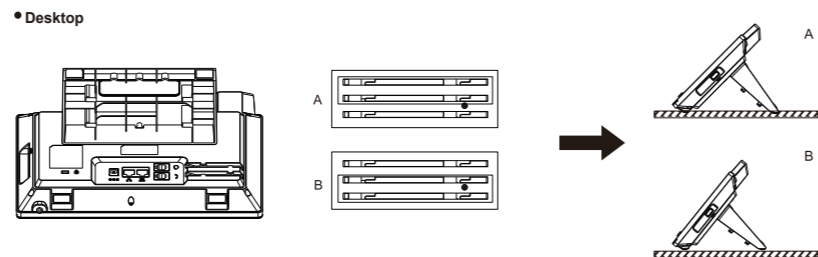

### • Wall-mounted

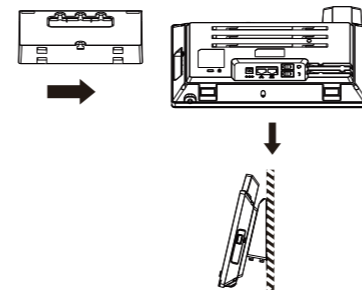

### • Gooseneck MIC installation

After aligning the gooseneck microphone with the port, load it and tighten the nut.

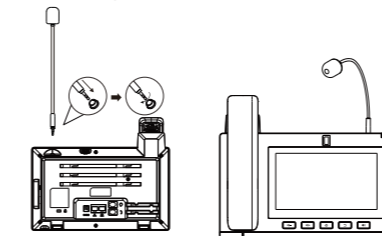

### Connection

Please connect power adapter, network, PC, headset, and headset with those ports as shown in the following figures.

- Power port: connect the power adapter.
- Network port: connecting local area network or internet.
- PC port: the network port connect to the computer.
- Headset port: connect headset.
- Handset port: connect IP Phone handset.
- USB port: connect USB device (USB flash drive)

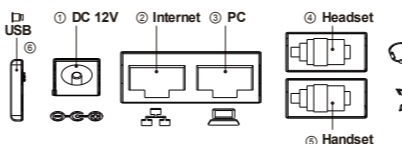

### Camera information

- Turn the knob to adjust the camera angle.

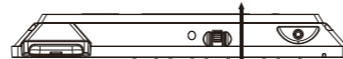

### Configuration

#### Configuration via Phone

- Press Phone Settings icon .
- Select Ethernet Settings: To configure the Network Settings (DHCP/Static).
- Select Line: To configure enable the account, fill the SIP server address, port, user name, password etc.

#### Configuration via Web

- Get the IP address from the phone: Press Phone Settings icon > Common.
- Login: Input the IP address in the web browser. The PC and phone should be in the same IP address segment (The default username and password are both 'admin').
- Configure: Select network/Account, etc. And fill the relevant content.

### Language setting

- Press Settings icon > System > Language & Input > Languages.
- Select the desired language.

### Making a call

- Pre-dialing:** enter the phone number and pick up the handset.
- Direct dialing:** lift the handset and enter the phone number.
- Handsfree:** enter phone number and press or vice versa.
- Headset:** enter phone number and press or vice versa.
- Dial icon:** Click dial icon and then enter the phone number.
- Designated line:** press line key, enter phone number and press dial key.

### Accepting a call

- With the handset:** pick up the handset.
- With a headset:** press .
- With the handsfree:** press .

### Putting a call on hold

- Press key or Hold icon, caller is put on hold.
  - To retrieve the call press key or Resume icon.
- Note:** with more than one active call, select desired call by sliding screen and use the corresponding icon to hold or resume.

### 3-party conference

- Once in line with 1st caller, press Conference icon, 1st caller is put on hold.
- Then call the 2nd number.
- After, 2nd call is established, press Conference icon to set up the conference.

### Call transfer

#### Attended transfer:

- Press Xfer icon during the active conversation, the call is put on hold.
- Dial the second telephone number.
- When the call is answered, then press Xfer icon to complete the operation.

#### Blind transfer:

- Press Xfer icon during the active conversation, the call will be on hold.
- Then enter the 2nd telephone number and press Xfer icon.

### Call forward

- Press Phone Settings icon > Line > Select the line > Forward Settings.
- Enter the destination number and the type of forward and press OK icon .

### Call Mute

- Press to Mute the microphone during the call.
- Press again to un-mute the conversation.

### Call list

- Press Call Logs icon .
- Touch the screen to scroll through the list.
- Select a number and click in the number area to make a call corresponding to the recorded number.

### Phonebook

#### Access phonebook:

- Press Contact icon .
- Select All Contacts or other group.
- To dial an entry, press Dial icon .

#### Add new entry:

- Click the contact icon in the menu .
- Press All Contacts or other group > Press Add icon.
- Enter name and number and press OK icon .

### Programmable keys

#### DSS virtual keys :

- You can use the phone web interface to configure the keys of the screen.
- Press unfold > you can press any keys which is still blank or long press the key that have configured, select a type and value, press .

#### Other keys :

- You can also configure shortcuts for the navigation keys and softkeys on web ui.
- You can press Phone setting icon > Key, select the SoftkeyScreen you need, then select among the configurable items, and select your desired type and value, press Save.

### Redial

- Touch the icon and select Redial number.

### Do not disturb

- Press DND icon when standby or click Phone Settings icon > DND.
- Select the Mode.

### Voice message

- To access your voice mailbox, press Voice message key or Voice message icon , number of message be indicated if provided by your server or PBX.
- Select the line and press phone icon to call.

### Wi-Fi

- Enter the Settings icon > Network & internet > Wi-Fi, enable Wi-Fi, and you can browse the list of available Wi-Fi.
- Select the available network, click on the network to enter the password to connect and click connect button.