

H1-2 Wire Quick Installation Guide

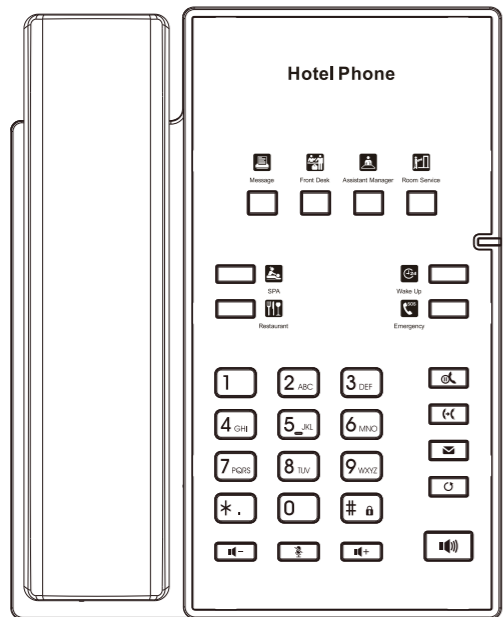

English (EN)

Precautions

Warning: Please do not power cycle the device during system boot up or firmware upgrade. You may corrupt firmware images and cause the unit to malfunction.

Warning: Use only the power adapter included in the device package. Using an alternative non-qualified power adapter may possibly damage the unit.

Overview

The H1-2 Wire phone upgrades the power supply and network connection method based on the original IP phone, using a 2-Wire connection. It features high-definition voice, fast deployment, 2 SIP accounts, support for 2-Wire power supply and network, 8 programmable keys, and other rich functions. It can meet various application scenarios and provide users with high-quality experience.

Packaging list

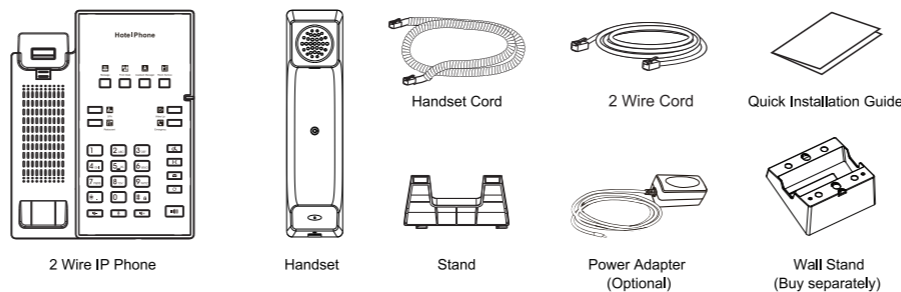

Keys description

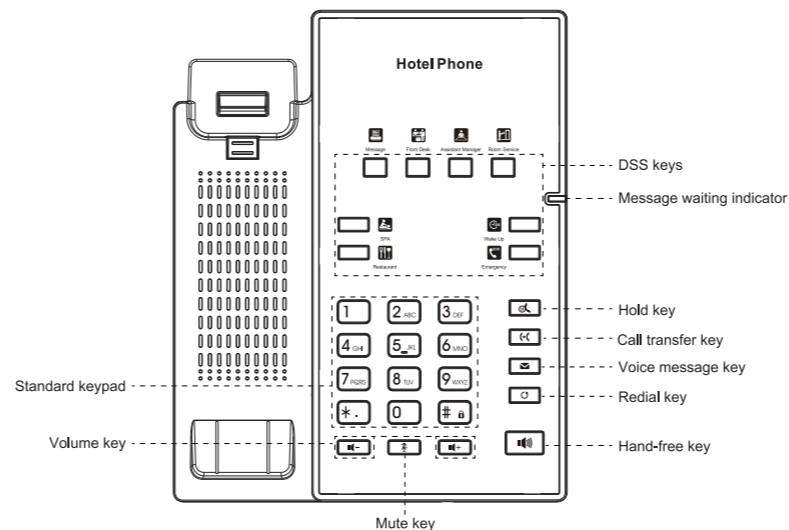

Device installation

Please follow the instructions in below picture to install the device.

• Bracket desktop installation

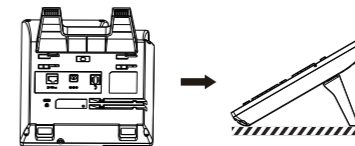

• Wall mounting (wall stand need buy separately)

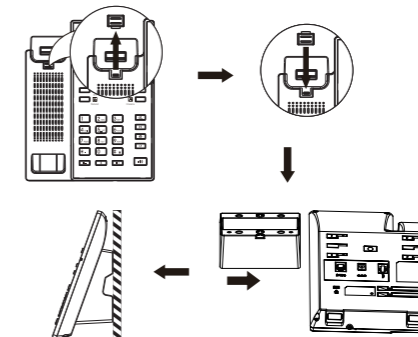

• Connecting to the device

Please connect power adapter, 2-wire, handset, and to the corresponding ports as described in below picture.

- ① 2-Wire port: connecting the 2-Wire interface.
- ② Power port: connect the power adapter.
- ③ Handset port: connect IP Phone handset.

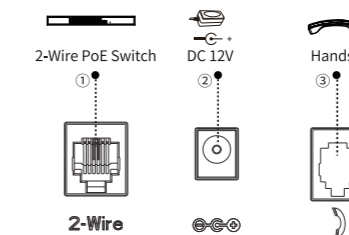

Note: You can contact your service provider for additional settings that may be necessary to configure the phone, or download the user manual and FAQ for more detailed information.

Network connect

Powered and networked through 2-wire

1. Turn on the power of the 2-Wire PoE switch, and connect the phone's 2-Wire interface to the 2-Wire PoE switch using a 2-wire cord.
2. The default is DHCP mode.

Phone configuration

Configuration via web

1. Get the IP address from the phone: Press the "*" key for more than 6 seconds to broadcast IP.
2. Login: Input the IP address in the web browser. The PC and phone should be in the same IP address segment (The default username and password are both "admin").
3. Configure: Select network/Account, etc. And fill the relevant content.
4. Save the configuration.

Making a call

1. **Pre-dialing:** enter the phone number and pick up the handset.
2. **Direct dialing:** lift the handset and enter the phone number.
3. **Handsfree:** enter phone number and press **☎** or vice versa.
4. **Memory key:** press memory key.

Accepting a call

1. **Using the handset:** pick up the handset.
2. **Using the handsfree:** press **☎**.

Redial

1. Press **☎** key, redial a call number.

Regulatory Compliance

Federal Communication Commission (FCC)—USA

This device complies with Part 15 of FCC Rules. Operation is subject to the following two conditions: (1) this device may not cause harmful interference, and (2) this device must accept any interference received, including interference that may cause undesired operation.

This equipment has been tested and found to comply with the limits for a Class B digital device, pursuant to Part 15 of the FCC Rules. These limits are designed to provide reasonable protection against harmful interference in residential installation. This equipment generates, uses, and can radiate radio frequency energy, and if it is not installed and used in accordance with the instruction manual, it may cause harmful interference to radio communications. However, there is no guarantee that interference will not occur in a particular installation. If this equipment does cause harmful interference to radio or television reception, which can be determined by turning the equipment off and on, the user is encouraged to try to correct the interference by one or more of the following measures:

- Reorient or relocate the receiving antenna.
- Increase the separation between the equipment and receiver.
- Connect the equipment into an outlet on a circuit different from that to which the receiver is connected.
- Consult the dealer or an experienced radio/TV technician for help.

简体中文 (ZH)

注意事项

警告: 请不要在设备启动未完成或设备升级软件时断开电源, 因为如刚才所述的操作将会导致话设备本身的程序损坏, 进而导致设备无法启动。

警告: 请使用设备包装中的电源适配器, 因为使用其他没有经过认证的替代电源适配器有可能对设备造成损害。

产品概览

H1-2 Wire话机在原有IP话机的基础上升级了供电网方式, 采用2-Wire连接, 具有高清语音, 快速部署等特点, 2个SIP账号, 支持2-Wire供电网, 8个快捷键等丰富功能; 可满足不同应用场景, 并提供优质的用户体验。

包装清单

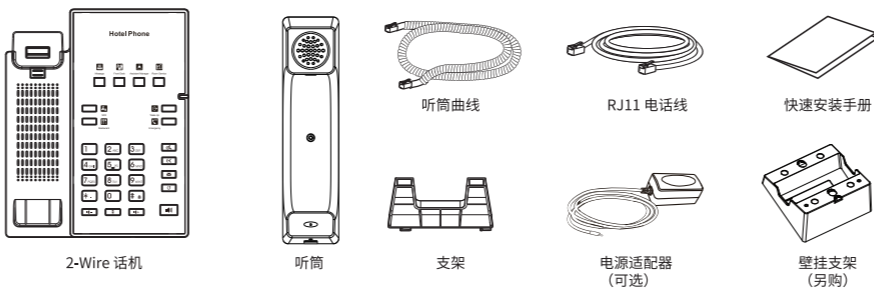

按键概览

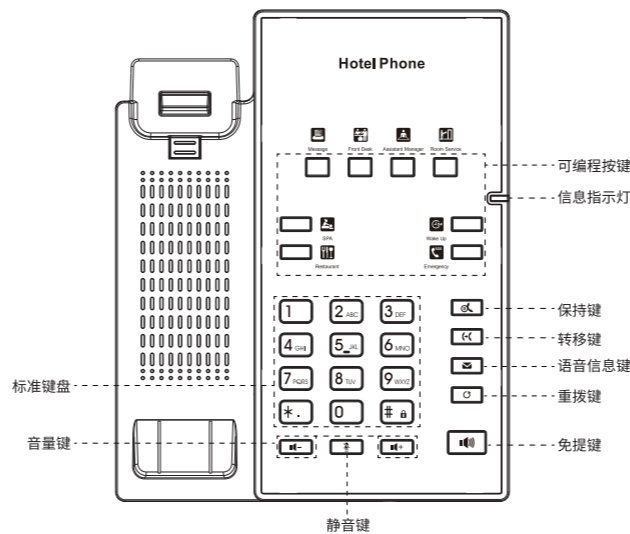

设备安装

请按照下面图片中的说明安装话机。

• 桌面支架安装

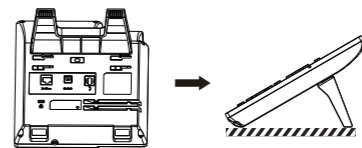

• 壁挂式安装 (壁挂支架需另外购买*分开销售)

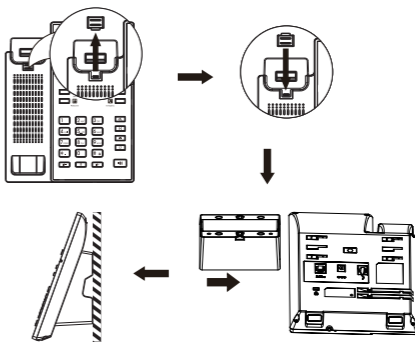

• 设备连接

请按下图说明将电源适配器, 2-Wire, 听筒, 连接到相应的端口。

- ① 2-Wire接口: 连接到2-Wire POE 交换机。
- ② 电源接口: 连接电源适配器。
- ③ 听筒接口: 连接话机听筒。

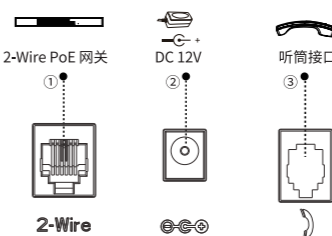

注意: 如有其他需要的设置, 请联系您的服务提供商, 或下载用户手册和常见问题解答以获得更详细的配置说明。

网络连接

通过2-Wire供电网连接

1. 打开设备电源, 并将话机的2-Wire接口连接到2-Wire POE 交换机, 使用2-Wire线缆连接。
2. 默认为DHCP模式。

电话设置

通过网页配置

1. 查询IP: 长按“#”(6秒以上)将语音播报IP。
2. 登录: 在网页浏览器上输入IP地址; 电脑和话机应该处于同一个IP地址段, 默认的用户名和密码都是“admin”。
3. 配置: 选择网络/账号等, 并填写相关内容。
4. 保存配置。

拨打电话

1. 预拨号: 先输入电话号码, 再拿起听筒。
2. 直接拨号: 先拿起听筒, 再输入电话号码。
3. 免提: 先输入电话号码, 再按下【M】; 顺序反之操作亦可。
4. 记忆键拨号: 按指定的记忆键呼叫。

接听电话

1. 使用听筒接听: 拿起听筒。
2. 使用免提接听: 按下【M】。

重拨

1. 按下【C】键, 重拨上一个呼叫号码。