

## Call Mute

1. Press **M** to Mute the microphone during the call.
2. Press **M** again to un-mute the conversation.

## Putting a call on hold

1. Press **H** key or Hold soft key, caller is put on hold.
  2. To retrieve the call press **H** key or Resume soft key.
- Note:** with more than one active call, select desired call with the **Navigation** keys and use the corresponding soft key to hold or resume.

## Call transfer

### Attended transfer:

1. Press **Transfer** key or Xfer soft key during the active conversation, the call is put on hold.
2. Dial the second telephone number.
3. When the call is answered, then press **Transfer** key or Xfer soft key to complete the operation.

### Blind transfer:

1. Press **Transfer** key or Xfer soft key during the active conversation, the call will be on hold.
2. Then enter the 2nd telephone number and press **Transfer** key or Xfer soft key.

## Call forward

1. Press Menu > Features > Call Forward.
2. Select the line, the type of forward, enter the destination number and status, and press OK soft key.

## Multiparty conference

1. Once in line with 1st caller, press **Conf** key or Conf soft key, 1st caller is put on hold.
2. Then call the 2nd number.
3. After, 2nd call is established, press **Conf** key or Conf soft key to set up the conference.

## Programmable keys

1. You can configure shortcuts for the programmable keys.
2. Press Menu > Basic > Keyboard, select among the configurable items, and select your desired type and value, press OK key.

## Do not disturb

1. Press DND soft key, and enable the device do not disturb mode.
2. Or press Menu > Features > DND, and select the Mode and Type, and press OK key.

## Voice mail

1. To access your voice mailbox, press **VM** or Menu > Message > Voice Message, number of messages will be indicated if provided by your server or pbx.
2. Select the line and press Play to call.

## Call list

1. Press **Call Log** key or Menu > CallLog > Local Call Logs.
2. Scroll through the list using **Navigation** keys.
3. To dial an entry, press Dial soft key or pickup handset or press **Call** or **Call**.

## Phonebook

### Access phonebook:

1. Press **Phonebook** or Contact soft key or Menu > Contact > Local Contacts.
2. Select All Contacts or other group.
3. To dial an entry, press Dial soft key or pickup handset or press **Call** or **Call**.

### Add new entry:

1. Press Contact soft key, Press All Contacts or other group > Press Add.
2. Enter name and number and press OK soft key.

# Fanvil

V1.02

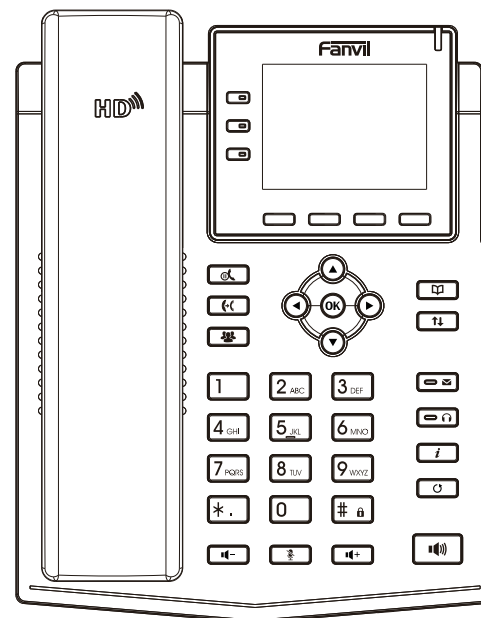

# X3U Pro

## Quick Installation Guide

Fanvil Technology Co., Ltd

Website: [www.fanvil.com](http://www.fanvil.com)

Email: [sales@fanvil.com](mailto:sales@fanvil.com) [support@fanvil.com](mailto:support@fanvil.com)

Tel: +86-755-2640-2199 Fax: +86-755-2640-2618

Add: 10/F Block A, Dualshine Global Science Innovation Center, Honglang North 2nd Road, Bao'an District, Shenzhen, China

Fanvil Technology Co., Ltd  
[www.fanvil.com](http://www.fanvil.com)

P/N:CJBA100228D0

## Packaging list

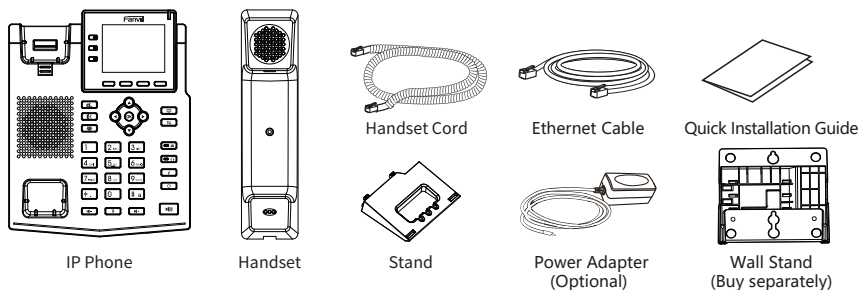

## Screen icon

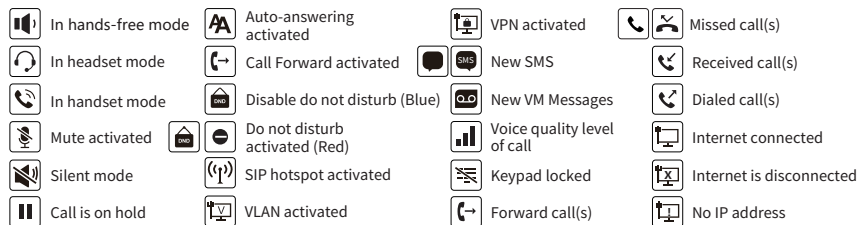

## Keys features

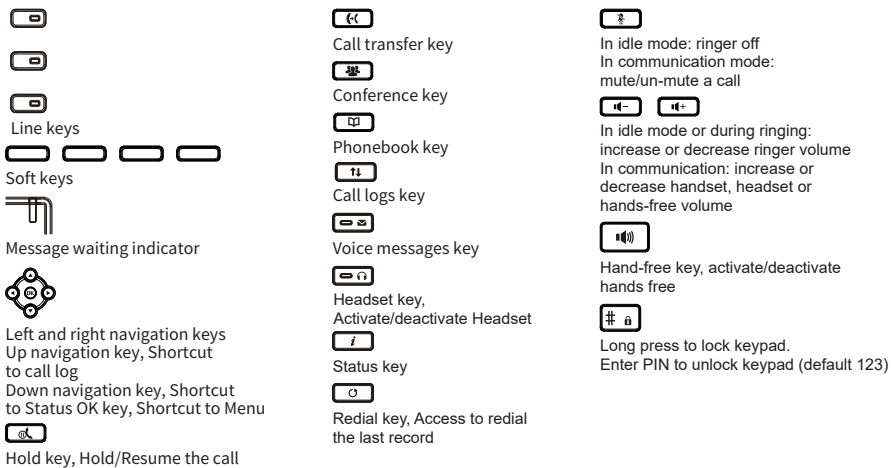

## Installation the device

Please follow the instructions in below picture to install the device.

### • Bracket desktop installation

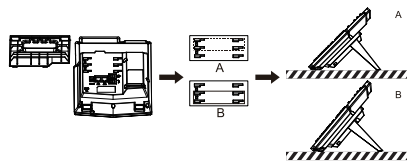

### • Wall mounting (Wall Stand need buy separately)

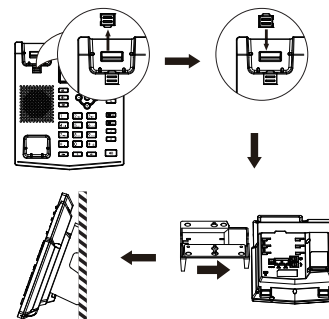

### Connecting to the Device

Please connect power adapter, network, PC, handset, and headset to the corresponding ports as described in below picture.

- Power port: connect the power adapter.
- Network port: connecting local area network or Internet.
- PC port: the network port connect to the computer.
- Headset port: connect headset.
- Handset port: connect IP Phone handset.

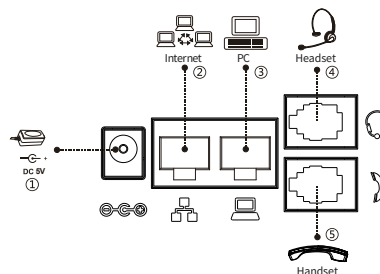

## Configuration

### Configuration via LCD menu of phone

- Press Menu > Advanced (default password 123)
- Select Network: To configure the Network Settings (IPv4/IPv6/IPv4&IPv6, DHCP/Static/PPPoE).
- Select Accounts: To configure enable the account, fill the SIP server address, port, user name, password etc.
- Save the configuration.

### Configuration via web

- Get the IP address from the phone: Press key, or Menu > Status > ETH.
- Login: Input the IP address in the web browser. The PC and phone should be in the same IP address segment (The default username and password are both 'admin').
- Configure: Select network/account etc, and fill the relevant content.
- Save the configuration.

## Language setting

- Press Menu key > Basic > Language.
- Select the desired language and press OK soft key.

## Making a call

- Pre-dialing:** enter the phone number and pick up the handset.
- Direct dialing:** lift the handset and enter the phone number.
- Handsfree:** enter phone number and press or vice versa.
- Headset:** enter phone number and press or vice versa.
- Designated line:** press line key, enter phone number and press dial key.

## Accepting a call

- Using the handset:** pick up the handset.
- Using the headset:** press .
- Using the handsfree:** press .

## Redial

- Press redial a call number.