

USEFUL TIPS

Below are some useful tips on common features.

Wireless content sharing

Konftel CC200 supports wireless content sharing from a laptop (Wireless Display/Miracast). For wired connection, the Konftel AV Grabber is required (optional).

Recording

You can record a meeting and store it on a connected USB storage device or on a network server.

Adding a Konftel speakerphone

Some situations might require adding a speakerphone to optimize both audio pick-up and sound distribution. Be careful to choose a model that is intended for the actual room size. The optional speakerphone can be connected via USB or Bluetooth.

Join a scheduled meeting

For easy click-to-join to a scheduled meeting, make sure the calendar is configured.

Videoconferencing features

During a videoconference, press **OK** on the remote control or the (⊞) icon on the floating bar to access all available videoconferencing features from the meeting menu.

Use of Android apps

With Konftel CC200 you can run any Android app (such as PowerPoint, Teams, Zoom etc.). Details on how to install and access the apps can be found in the Konftel CC200 User Guide at konftel.com.

More details about features can be found in the Konftel CC200 User Guide at konftel.com

Konftel is a leading company within collaboration endpoint solutions. Since 1988, our mission has been to help people in businesses around the world to have meetings regardless of distance. Based on our success, we know that remote collaboration is a smooth way to save time, money and at the same time contribute to a more sustainable world.

Crystal clear audio and a sharp video image are essential for efficient meetings, this is why we only focus on cutting-edge technology in our Collaboration Solutions. Our audio technology OmniSound® is built into all Konftel Conference phones and devices. The products are sold globally under the Konftel brand and our headquarter is based in Sweden. Read more about the company and our products at konftel.com.

Konftel AB, Box 268, SE-901 06 Umeå, Sweden

Tel: +46 90 70 64 89 E-mail: info@konftel.com



Konftel is a Climate Neutral certified company. We have measured and offset our entire footprint of greenhouse gas, and are committed to reduce our emissions.



P/N 700515377 A01

700515377 Rev A



QUICK GUIDE Konftel CC200

OmniSound®    



 **KONFTEL**

WHAT'S IN THE BOX



Konftel CC200



Lens Cap



HDMI Cable



Wall mount
4 screws 4 x 40mm
4 plug 6 x 40mm
1 tripod UNC screw



Remote Control with
2 AAA batteries



90° HDMI Adapter



Power Adapter
with regional
converters

Konftel CC200 User Guide is available at konftel.com

CONNECTIONS

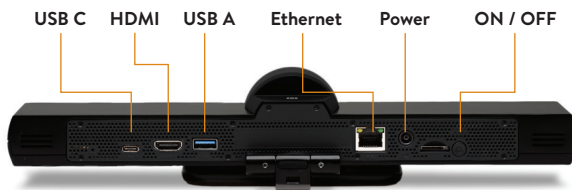

INSTALLATION

1. Place the Konftel CC200 on top of the screen and use its hinge to secure it, or use the wall mount.



2. Plug the HDMI cable into the screen and CC200. Use the included HDMI adapter in case there are not enough space between Konftel CC200 and the wall.

3. Plug in the power adapter.

ADJUST THE ANGLE OF THE LENS

During first installation, you can adjust the angle of the camera lens manually by easily pushing the lens housing in the desired direction, both right/left and up/down.



Digital Pan Tilt Zoom is managed from the remote control or in the user interface (📷).

BASIC SETTINGS

Before first use, the basic network settings are required. Details about the settings can be found in the User Guide at konftel.com. For web interface access to Konftel CC200, the default credentials are User: **Admin**, Password: **1234**.

REMOTE CONTROL

The remote control provided in the box is a pre-paired wireless device.

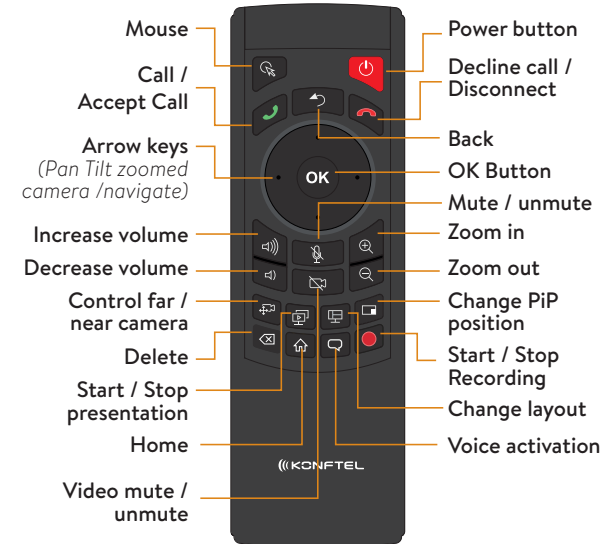

Function key
(enables/disables
yellow digits /
symbols)

Arrow keys
(Pan Tilt
Zoomed camera
/ navigate)

Battery cover
(push and slide
for opening)