



CP-8851 / CP-8861

Do Not Ship Enclosure with Phone Installed  
[PHONE MUST BE INSTALLED ON-SITE]

## CP-8851 / 9961 Mounting the Enclosure

Take into consideration before you install:

- Due to the size and mass of this product, it is important that the Backbox is safely installed according to these installation instructions.
- Make sure that the type of wall is capable of supporting the system and use screws that are suitable for that type of wall.
- The system must be installed by qualified personnel, in accordance with state and local building regulations.
- See sheet five and ten for Conduit and Wall Mounting instructions.

# Accessory Kits

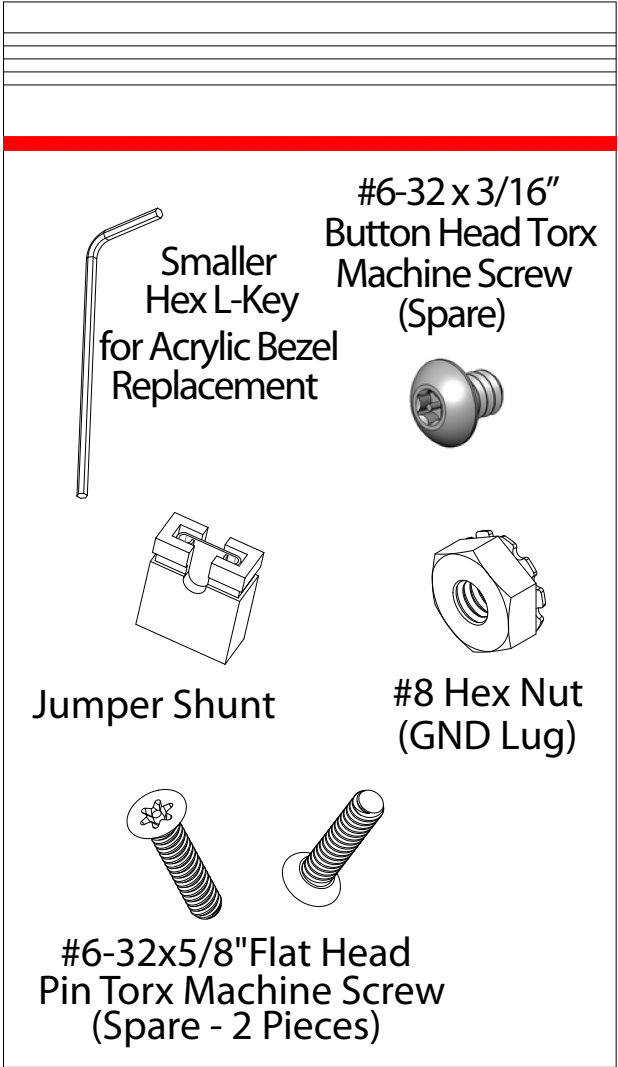

Torx Sec. Bit & Spare Screw Kit

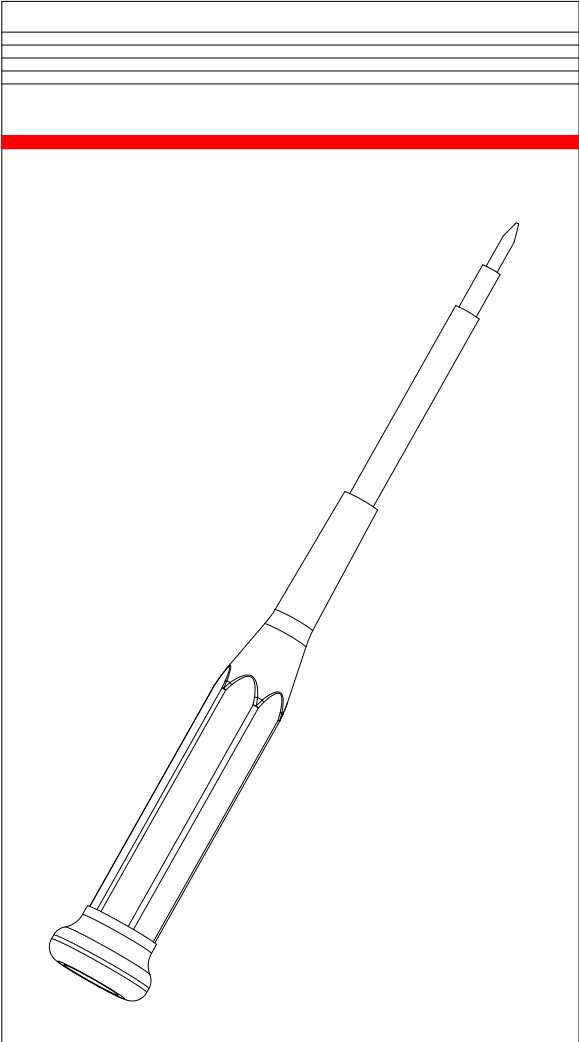

#00 Screw Driver Kit

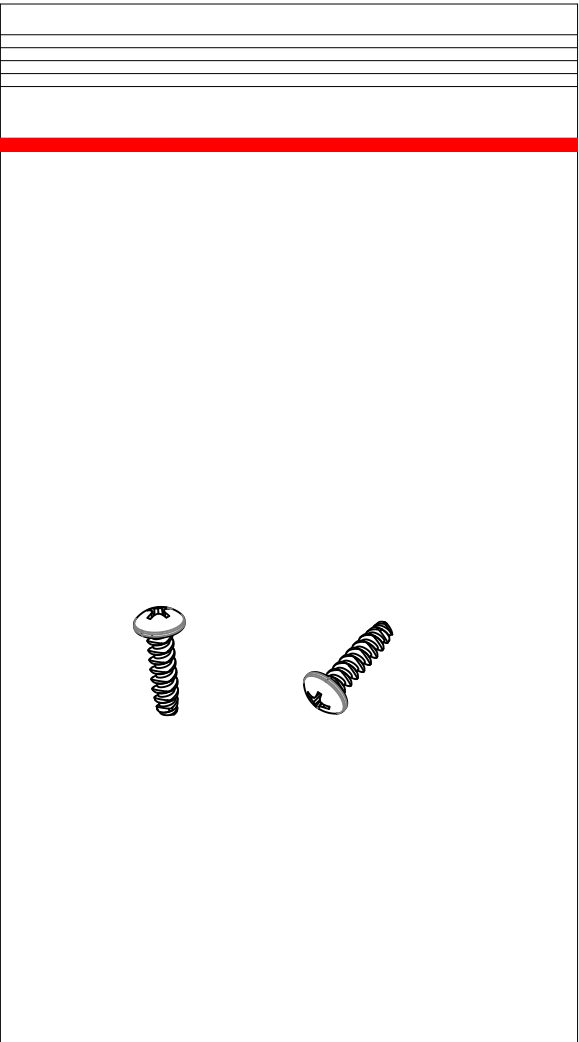

Phone Mounting Screw Kit

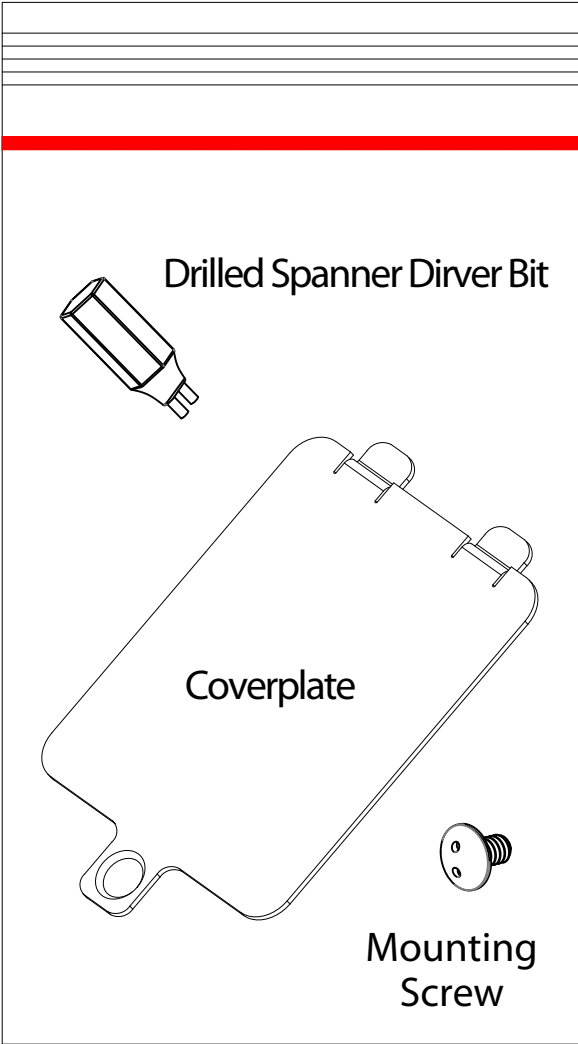

Keypad Cover Accessory Kit

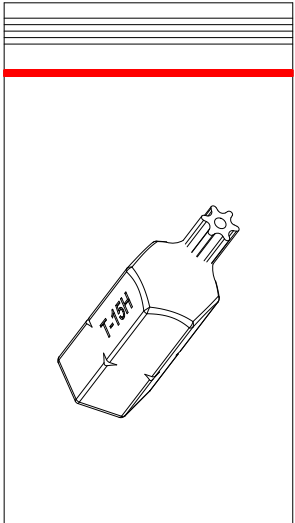

T-15 Pin Torx Security Driver Bit

Remove Handset, USB & KEM Covers,  
Install all Cables then the Mounting Bracket

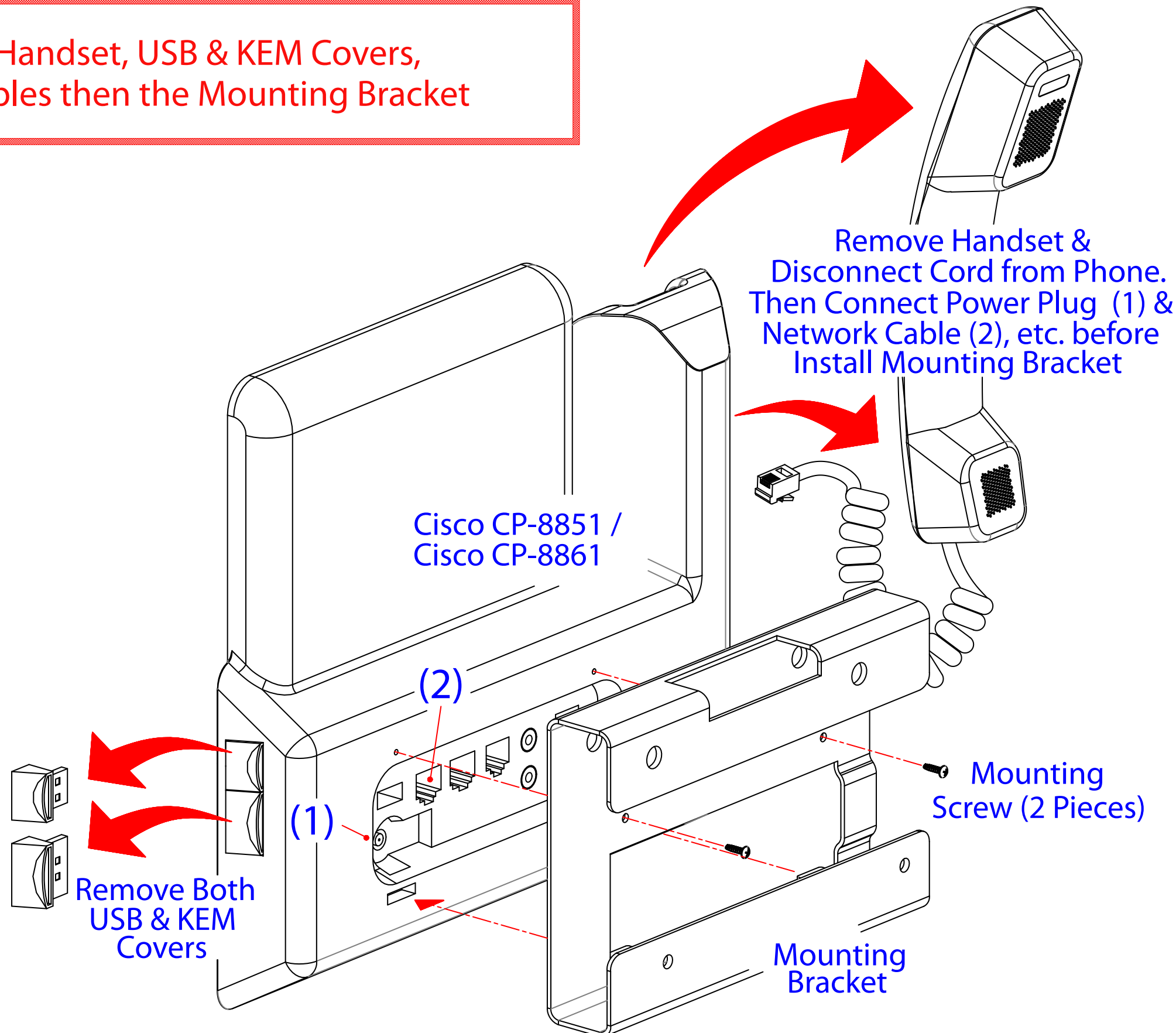

**Plug in the USB Cable**

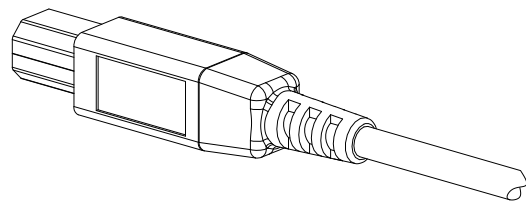

USB-B Plug in to  
USB to Analog Audio Module  
(See Sheet 6 of 10)

Right Angle  
USB-A Plug

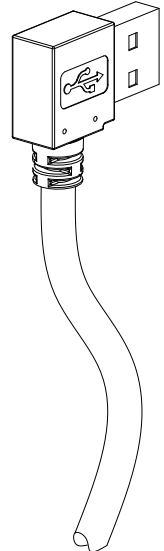

USB Port

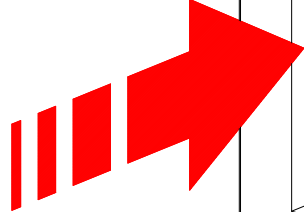

AUX

AUX  
Cable

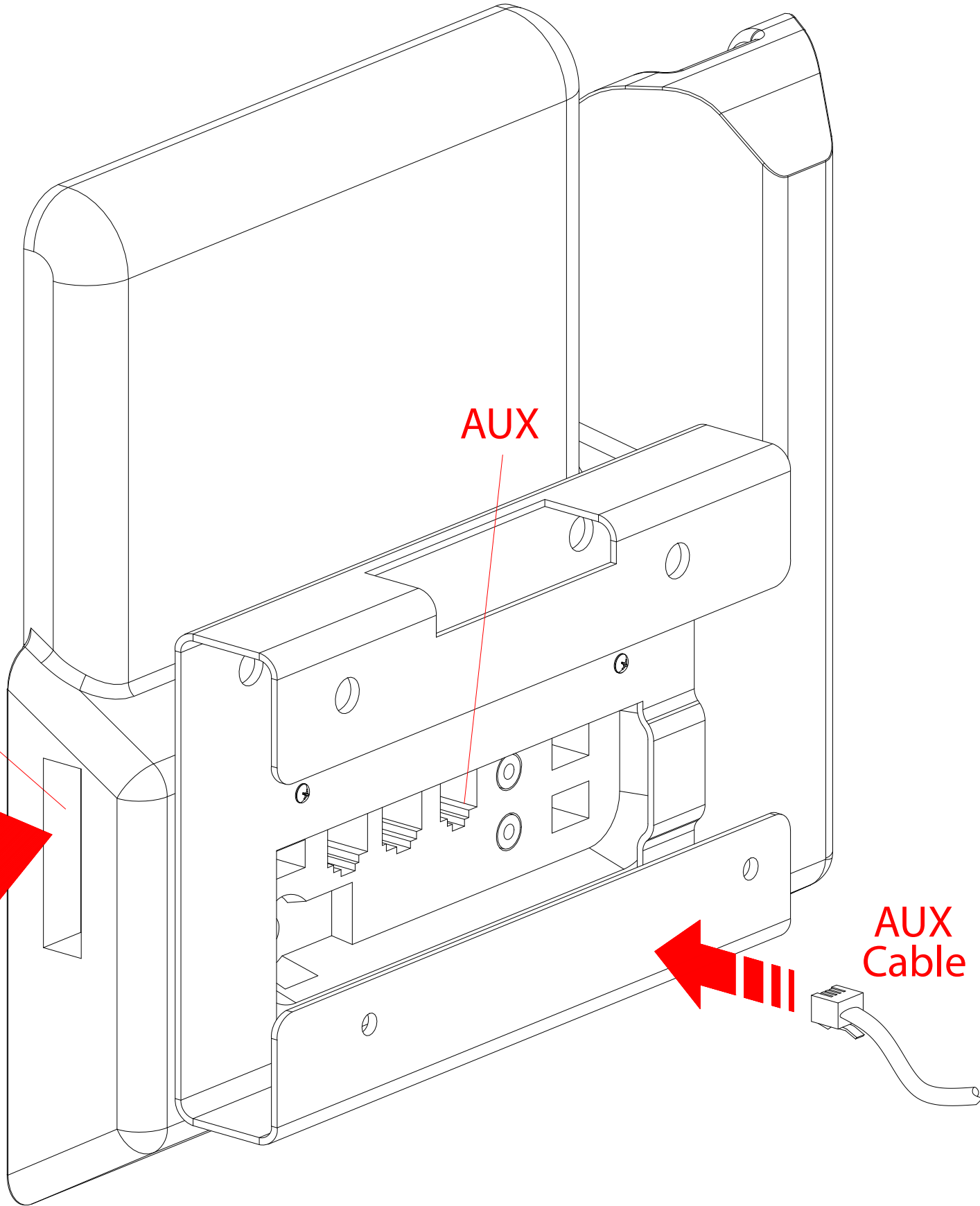
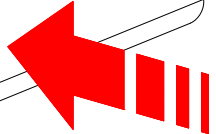

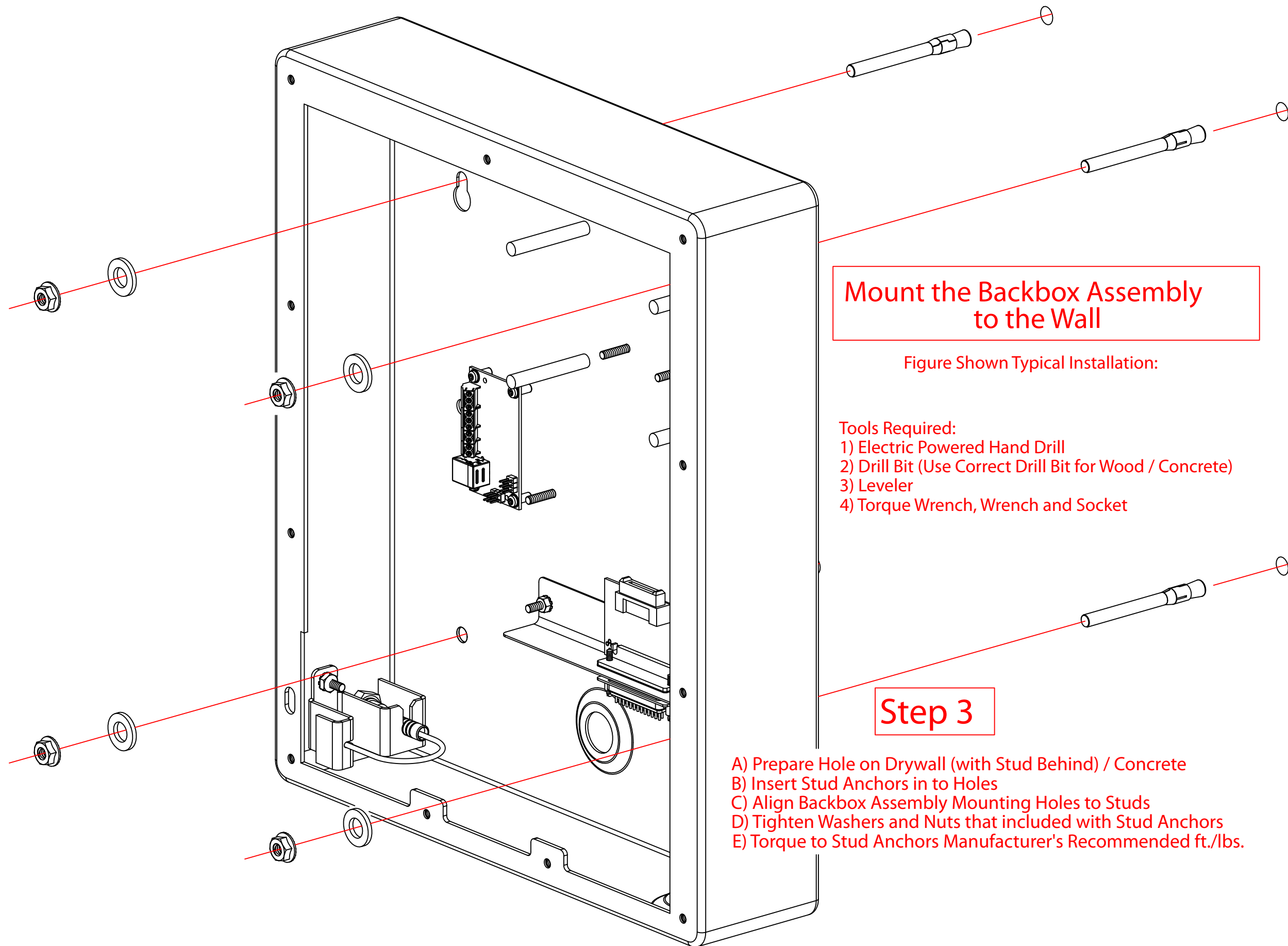

## Mount the Backbox Assembly to the Wall

Figure Shown Typical Installation:

- Tools Required:
- 1) Electric Powered Hand Drill
  - 2) Drill Bit (Use Correct Drill Bit for Wood / Concrete)
  - 3) Leveler
  - 4) Torque Wrench, Wrench and Socket

### Step 3

- A) Prepare Hole on Drywall (with Stud Behind) / Concrete
- B) Insert Stud Anchors in to Holes
- C) Align Backbox Assembly Mounting Holes to Studs
- D) Tighten Washers and Nuts that included with Stud Anchors
- E) Torque to Stud Anchors Manufacturer's Recommended ft./lbs.

# Hookswitch Cradle to Handset Connections

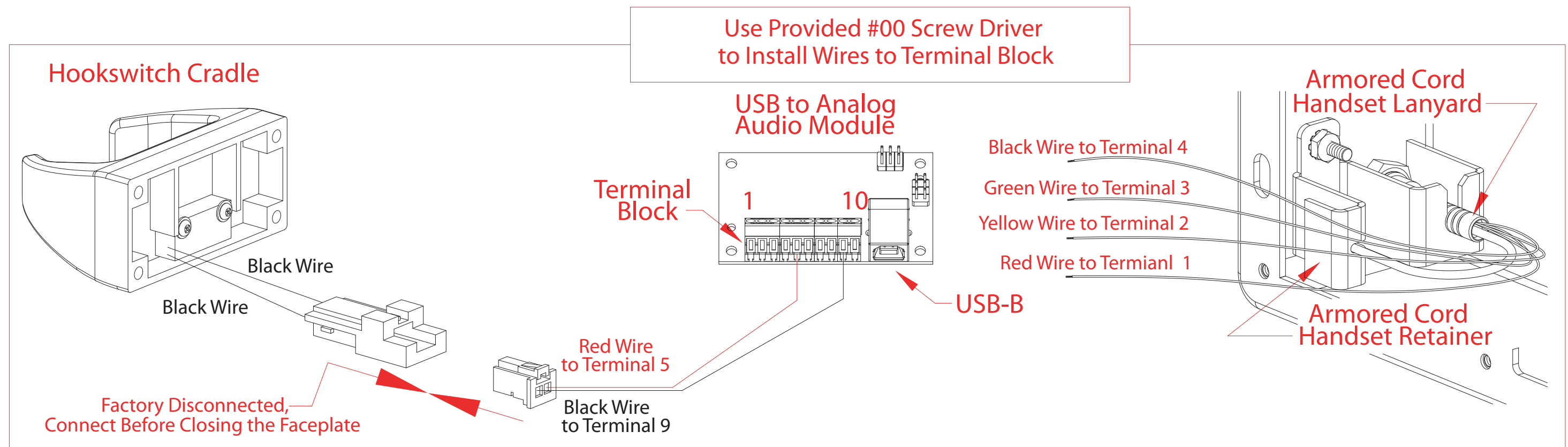

Install Shunt on JP2  
to Enable Auto Answer Mode

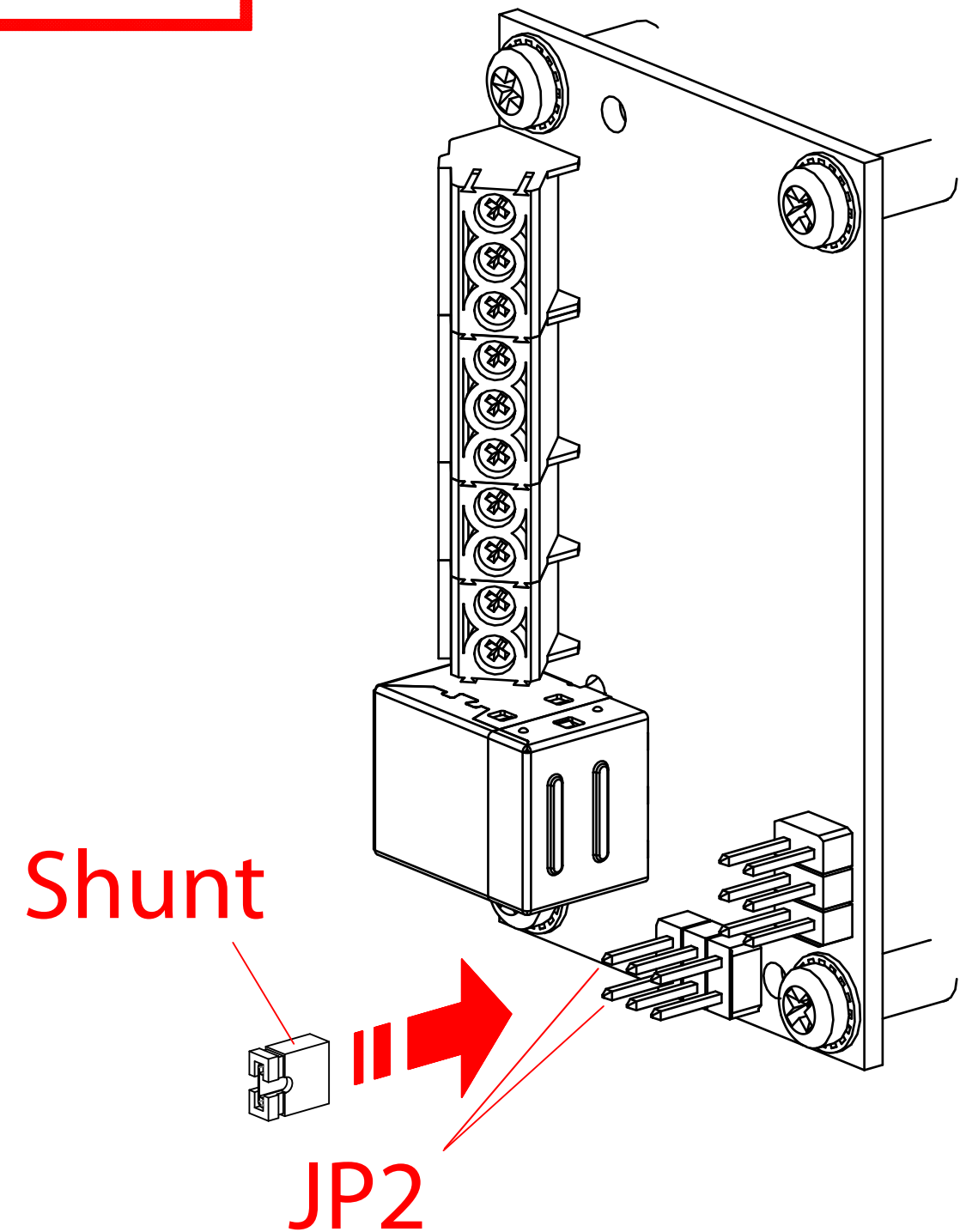



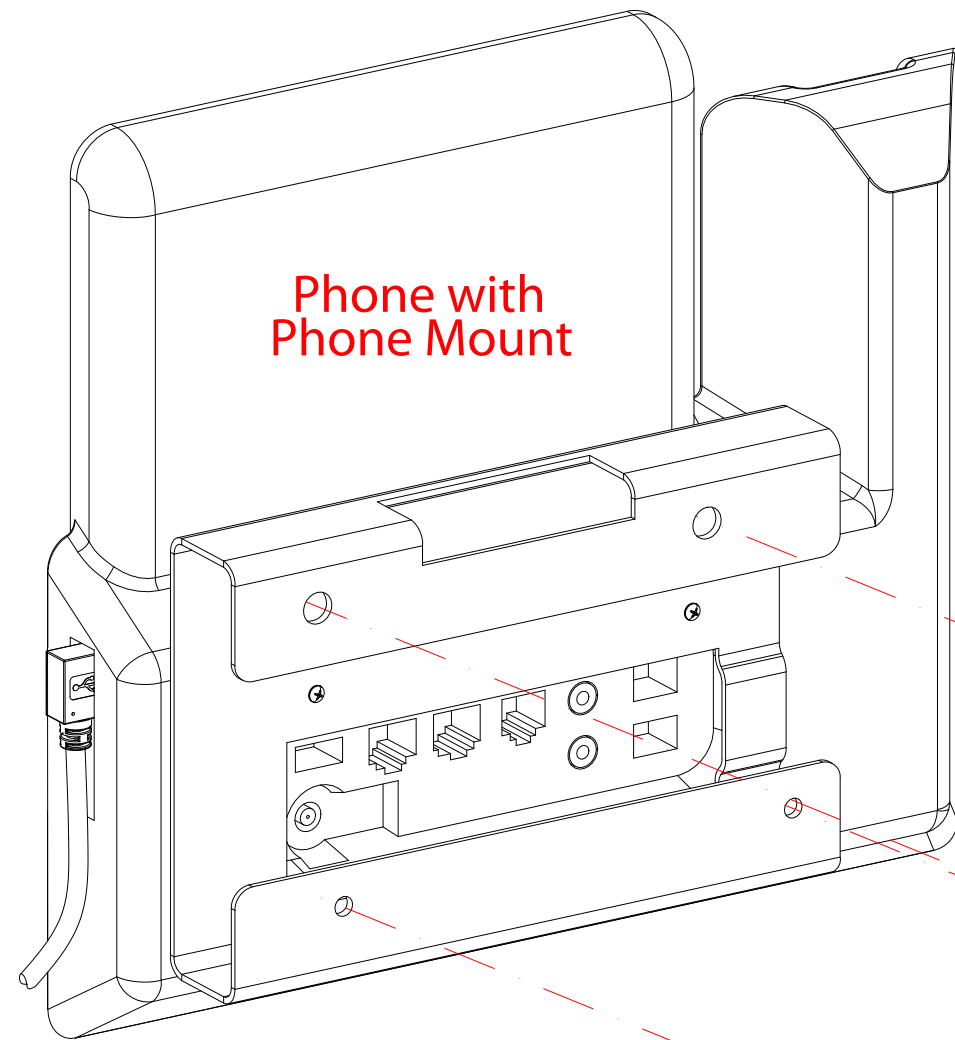

Phone with  
Phone Mount

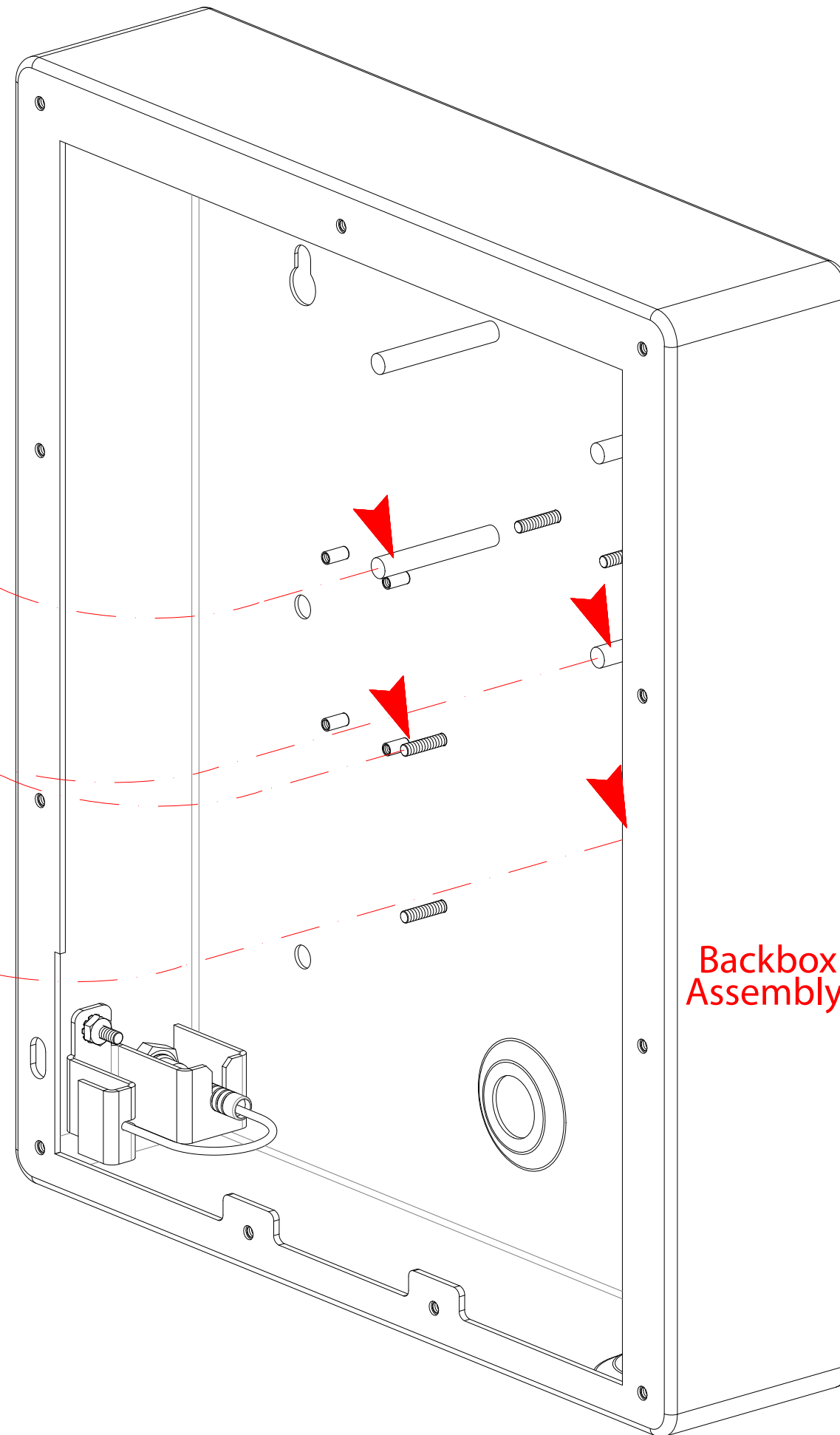

Backbox  
Assembly

Intall Phone with Phone Mount  
to Backbox

Use Provided Security Torx Driver Bit to Fasten Screws to Backbox

Tool Required:  
Electric Hand Drill or  
Powered Screwdriver

Torx Screw (11x)

Faceplate  
Assembly

Backbox  
Assembly

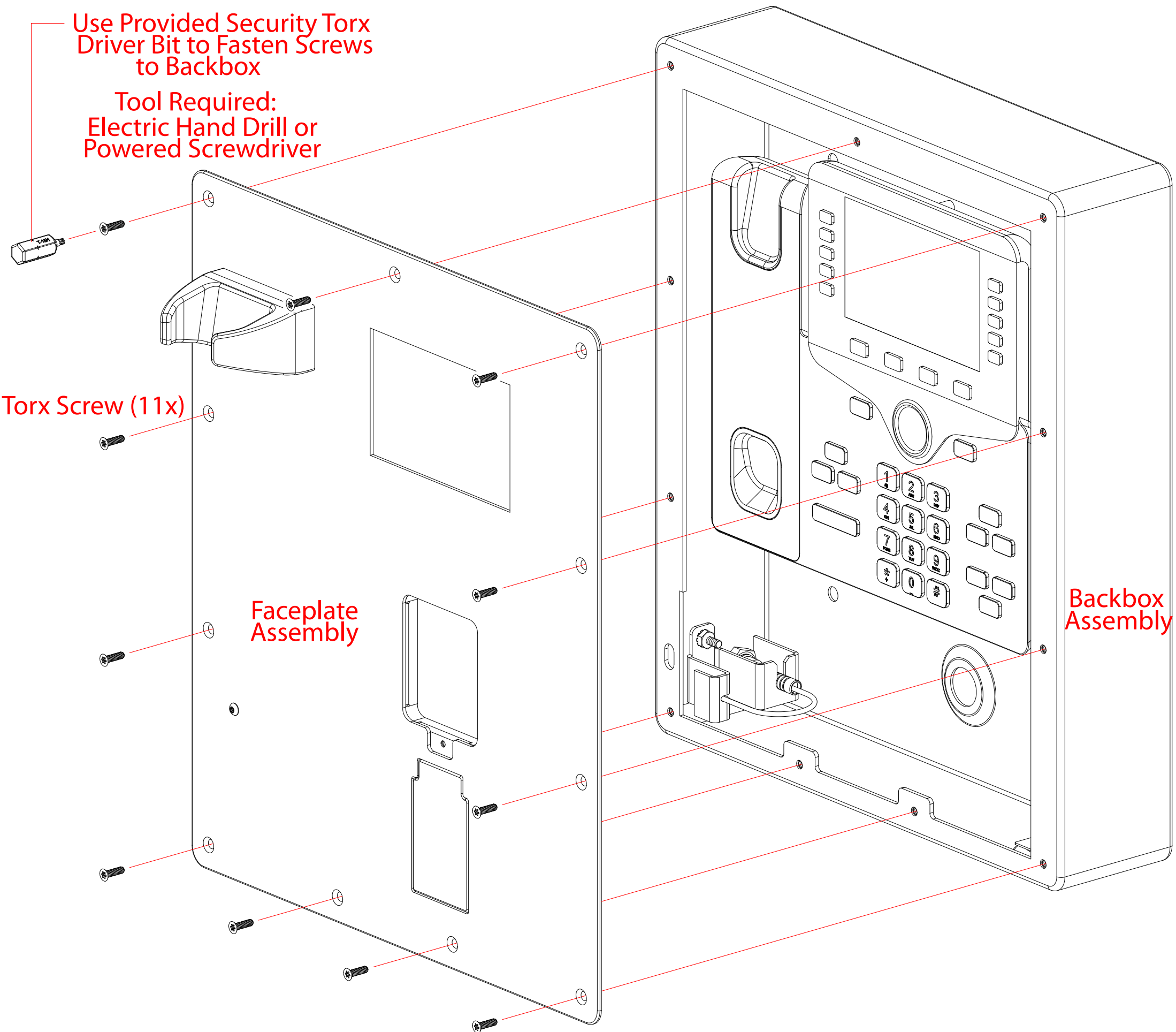

# Dimensions and Features

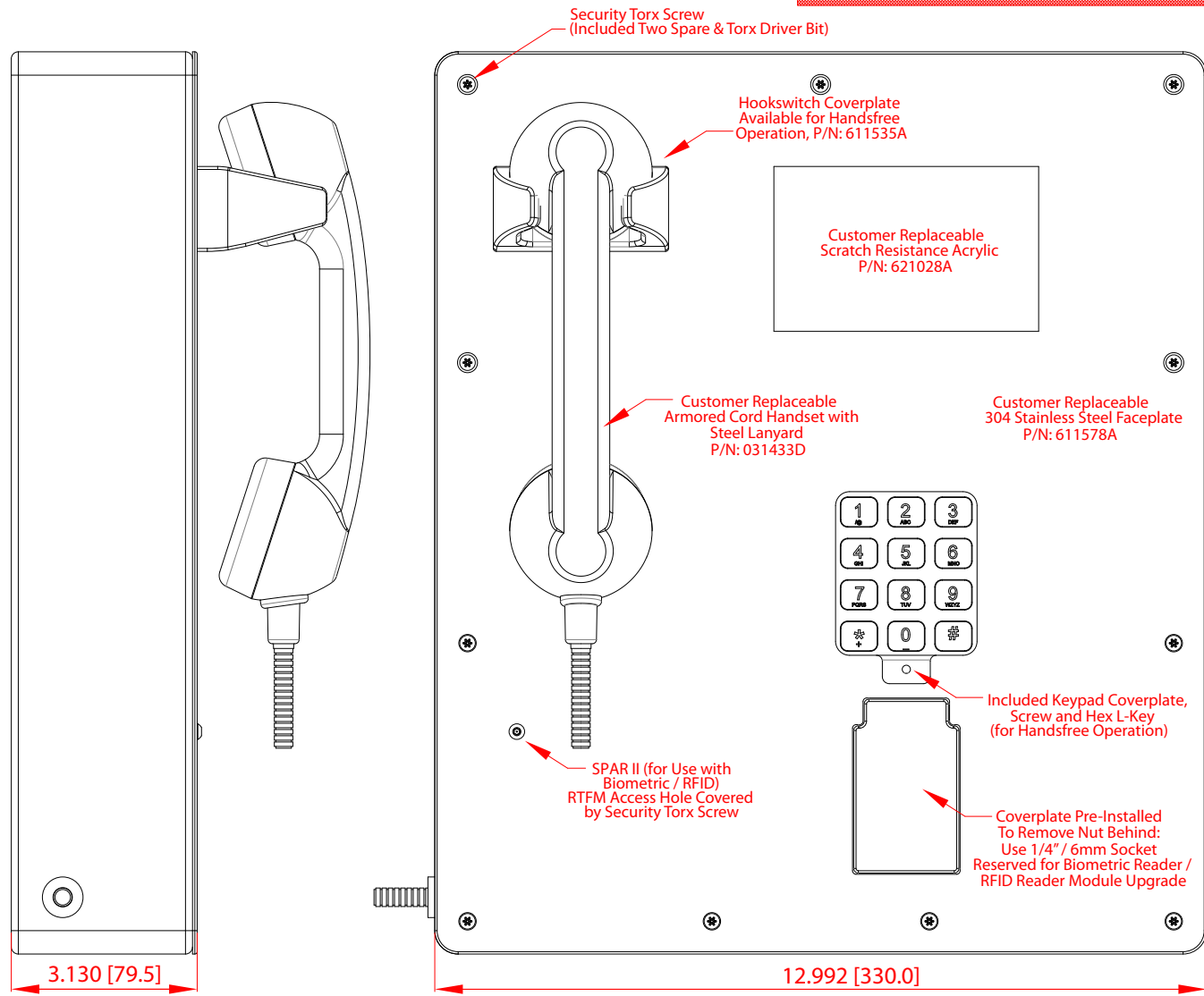

DIMENSIONS ARE IN INCHES [MILLIMETER]

