

# Singlewire InformaCast Paging Amplifier

CyberData

The IP Endpoint Company



The new Singlewire Paging Amplifier is for use with Singlewire's paging and emergency notification software InformaCast® or InformaCast CK. This PoE-powered device now includes some brand new features such as dual registration for both Singlewire and SIP, and hooks up easily to new and existing Singlewire installations, providing an easy method for implementing a loud IP-based overhead paging system for loud areas, warehouses, manufacturing areas, and outdoor areas.

Now with up to 9 user-stored messages, the Amplifier provides direct drive of up to two 8 Ohm horns.

The interface is compatible with most SIP-based IP PBX servers that comply with the SIP RFC 3261. For non-SIP environments, the Paging Amplifier can be configured to listen to multicast address and port number combinations to form paging zones.



Loudspeaker (part #011068) must be purchased separately.

## New Features

- Now offers dual registration for both SIP and Singlewire
- SIP Enhanced interoperability for hosted environments
  - CyberData has maintained one of the most comprehensive list of IP PBX servers certified to work with CyberData
- NEW SECURITY FEATURES:
  - Support for security code access for SIP paging
  - Autoprovisioning via HTTPS
  - HTTPS web based configuration
- Support for G.722 codecs
- 802.11q VLAN tagging
- Configurable sense input for use with fault detection or lighted button kit
- Configurable event generation for device health and status monitoring
- Optional direct connect RGB strobe kit connection (coming soon)
- 9 user-uploadable page messages

## Features

- SIP and Simultaneous Multicast
- Dual-speed ethernet 10/100 Mbps
- Web-based configuration
- PoE 802.3at and 802.3af-enabled
- Line-in for background music
- Line-out connector
- DTMF controlled relay
- Direct 8 Ohm speaker drive
- User-uploadable tones and messages
- Digital and manual volume control
- Second SIP endpoint "Night Ringer"
- Autoprovisioning
- Auto-call voice message from input port sense
- Can support two horns
- HTTP Command Interface
- 10 channel prioritized Multicast ports
- Built-in diagnostics
- Delayed page support
- Cisco SRST

## Specifications

Ethernet I/F	10/100 Mbps
Protocol	InformaCast and SIP RFC 3261 Compatible
Power Input	PoE 802.3at or 802.3af
Audio Output	802.3af - SPL 114 dB @ 1 meter* 802.3at - SPL 117 dB @ 1 meter*

### Line In:

Input Signal Amplitudes	2.0 VPP maximum
Input Impedance	10k Ohm

### Line Out:

Output Signal Amplitudes	2.0 VPP maximum
Output Level	+2dBm nominal
Total Harmonic Distortion	0.5% maximum
Output Impedance	10k Ohm

Operating Temperature	-10° C to 50° C (14° F to 122° F)
-----------------------	-----------------------------------

Payload Types	G.711 a-law, G.711 μ-law , and G.722
---------------	--------------------------------------

Dimensions**	1.042 in. [26.5 mm] Length 3.295 in. [83.7 mm] Width 7.795 in. [198.0 mm] Height
--------------	--

Weight	1.4 lbs. [0.63 kg]
Boxed Weight	2.0 lbs. [0.90 kg]

Warranty	2 Years Limited
----------	-----------------

Part Number	011403
-------------	--------

Loudspeaker Part Number	011068
-------------------------	--------

\*When used with the 011068 Mini Horn.

\*\*Dimensions are measured from the perspective of the product being upright with the front of the product facing you.

## Singlewire InformaCast Features

- Singlewire Informacast compatibility available.
- Includes support for Informacast resiliency.
- Supports both SIP and Singlewire InformaCast
- InformaCast compliant
- InformaCast CK compliant

# Singlewire InformaCast Paging Amplifier

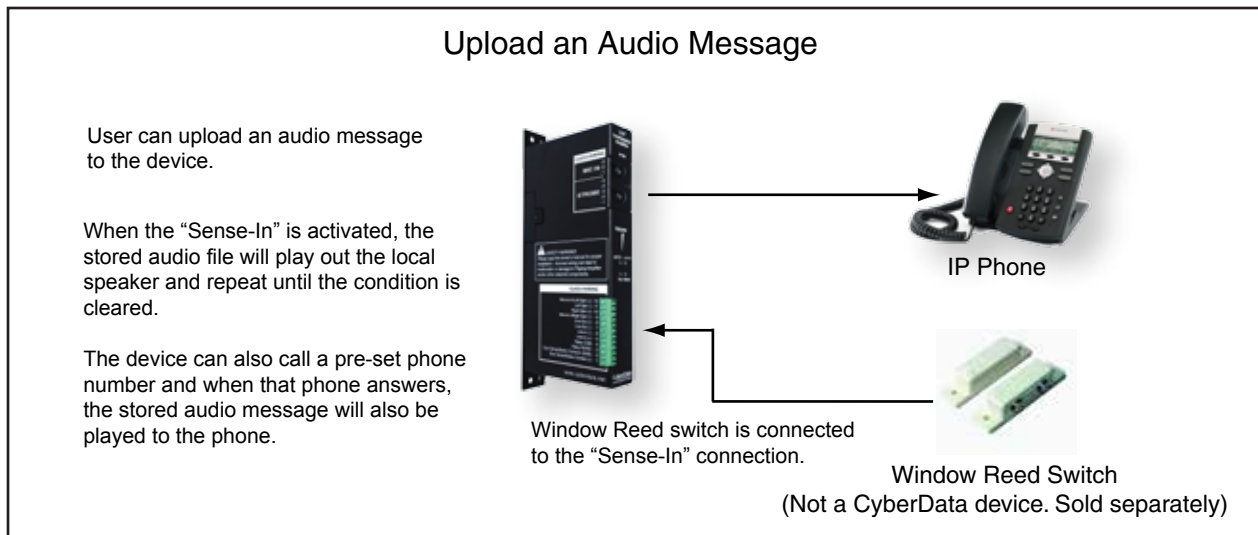
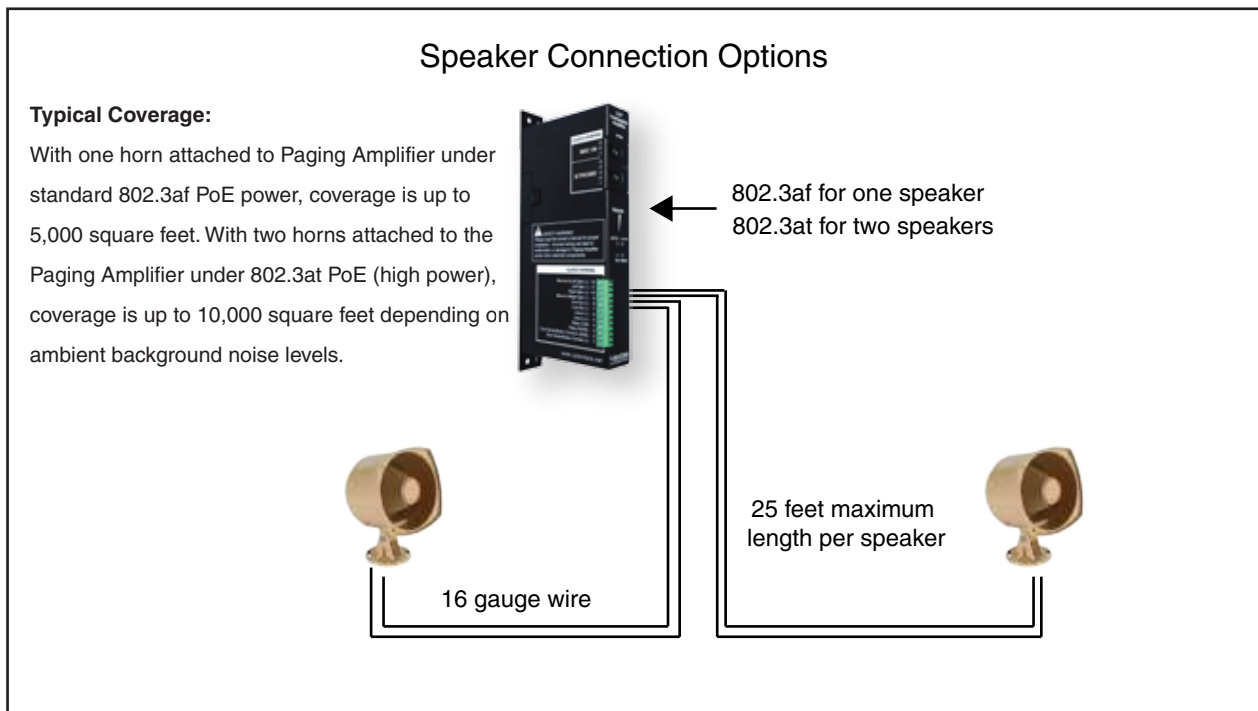
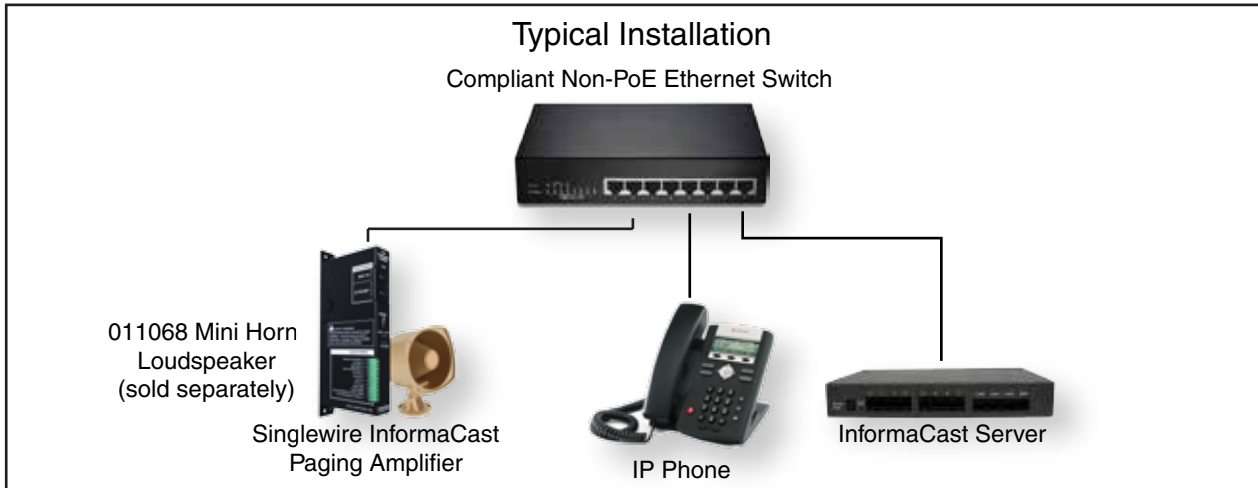

# Singlewire InformaCast Paging Amplifier

